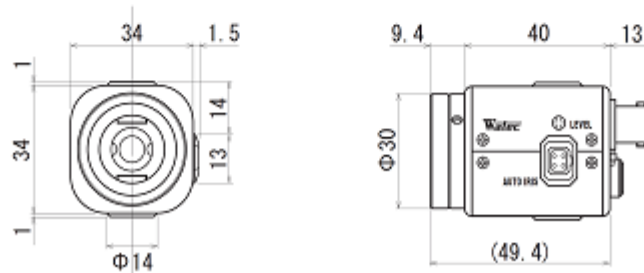

**SPECIFICATIONS**

Model		WAT-241 (NTSC)	WAT-241 (PAL)
Pick-up element		1/4 inch interline transfer CCD image sensor	
Number of total pixels		811(H) × 507(V)	795(H) × 595(V)
Number of effective pixels		768(H) × 494(V)	752(H) × 582(V)
Unit cell size		4.9µm(H) × 5.6µm(V)	5.0µm(H) × 4.7µm(V)
Imaging system		Ye, Cy, Mg, and G complementary color mosaic filters on chip	
Synchronizing system		Internal	
Scanning system		2:1 interlace	
Video output		Composite Video, 1Vp-p, 75ohms, unbalanced	
Resolution (Horizontal)		450TVL (Center)	
Minimum illumination		0.6lx F1.2	
S/N		More than 50dB (AGC=6dB, $\gamma=1.0$ )	
AE mode	Fixed	1/60sec.	1/50sec.
	EI	1/60 - 1/100000 sec.	1/50 - 1/100000 sec.
White balance		ATW (2500K - 9500K)	
AGC		6 - 30dB	
Gamma characteristics		$\gamma \approx 0.45$	
Lens iris		Video / DC (EIAJ arrangement, Auto-select)	
Back light compensation		ON	
Power supply		DC+12V±10%	
Power consumption		0.96W (80mA)	
Operating temperature		-10°C - +40°C	
Storage temperature		-30°C - +70°C	
Operating / Storage humidity		Less than 95% RH (Without condensation)	
Lens mount		CS mount	
Weight		Approx. 82g	

※Design and specifications are subject to change without notice.

**DIMENSIONS (mm)****SDT - Dr. Seitner GmbH**

MUEHLBACHSTR. 20 PHONE: +49 8152 37200  
D-82229 SEEFELD FAX: +49 8152 79880

E-MAIL: [org@sdt-seitner.com](mailto:org@sdt-seitner.com)  
HOMEPAGE: [www.sdt-seitner.com](http://www.sdt-seitner.com)